



**Dorset
Council**

Wildlife and Countryside Act 1981

Dorset Council

County of Dorset Definitive Map and Statement of Rights of Way

**Dorset Council (Parts of Footpath 17, Woodlands at Slough House)
Definitive Map and Statement Modification Order 2023**

This Order is made by Dorset Council under section 53(2)(b) of the Wildlife and Countryside Act 1981 ("the Act") because it appears to that authority that the County of Dorset Definitive Map and Statement require modification in consequence of the occurrence of an event specified in section 53(3)(c)(i) namely, that a right of way which is not shown in the map and statement subsists or is reasonably alleged to subsist over land in the area to which the map relates and section 53(3)(c)(iii) namely, that there is no public right of way over land shown in the map and statement as highway of any description or that any other particulars contained in the map and statement require modification.

The authority have consulted with every local authority whose area includes the land to which the Order relates. Dorset Council hereby order that:

1. For the purposes of this Order the relevant date is 9 December 2022.
2. The County of Dorset Definitive Map and Statement shall be modified as described in Part I and Part II of the Schedule and shown on the map attached to the Order.
3. This Order shall take effect on the date it is confirmed and may be cited as the "Dorset Council (Parts of Footpath 17, Woodlands at Slough House) Definitive Map and Statement Modification Order 2023".

Dated this 24TH day of FEBRUARY 2023

THE COMMON SEAL OF
DORSET COUNCIL

was fixed in the presence of:-



Authorised Signatory

SCHEDULE

(The points specified relate to the map attached to the Order and their positions are identified by national grid references)

Part I

Modification of definitive map Description of path to be deleted

Parts of Footpath 17, Woodlands:

- A – B The whole width of the footpath from the unaffected part of Footpath 17, in the north western corner of a field at point A (SU 05520754), south east across fields and crossing the river to rejoin the unaffected part of Footpath 17 at point B (SU 05570743). (No recorded width).
- C – D The whole width of the footpath from the unaffected part of Footpath 17, east of Slough House at the concrete driveway at point C (SU 05760738), east north east and north east to its junction with Bridleway 13 at Slough Lane at point D (SU 05780739). (No recorded width).

Description of paths to be added

Parts of Footpath 17, Woodlands:

- A – E – F
– B From the unaffected part of Footpath 17, in the north western corner of a field at point A (SU 05520754), south across the field to point E (SU 05520748) then continuing generally south south east across the field to point F (SU 05540744) and east, crossing the river, to rejoin the unaffected part of Footpath 17 at point B (SU 05570743). Width: 2 metres.
- C – G From the unaffected part of Footpath 17, east of Slough House at the concrete driveway at point C (SU 05760738), generally north north east along the driveway and across the corner of a field to its junction with Bridleway 13 at Slough Lane at point G (SU 05780741). Width: 2 metres.

Part II

Modification of definitive statement Variation of particulars of path

Footpath 17, Woodlands:

Delete:

From: 047083 To: 058074

Path No 15 near Woodlands Farm to join Path No 13 at Knobs Crook.

Add:

From: SU 047083 To: SU 05780741

Path No 15 near Woodlands Farm generally south south east and east to the north western corner of a field at SU 05520754, south across the field to SU 05520748 then continuing generally south south east across the field to SU 05540744 and east, crossing the river, to SU 05570743. Continuing east south east to the concrete driveway at SU 05760738 then generally north north east along the driveway and across the corner of a field to its junction with Bridleway 13 at Slough Lane.

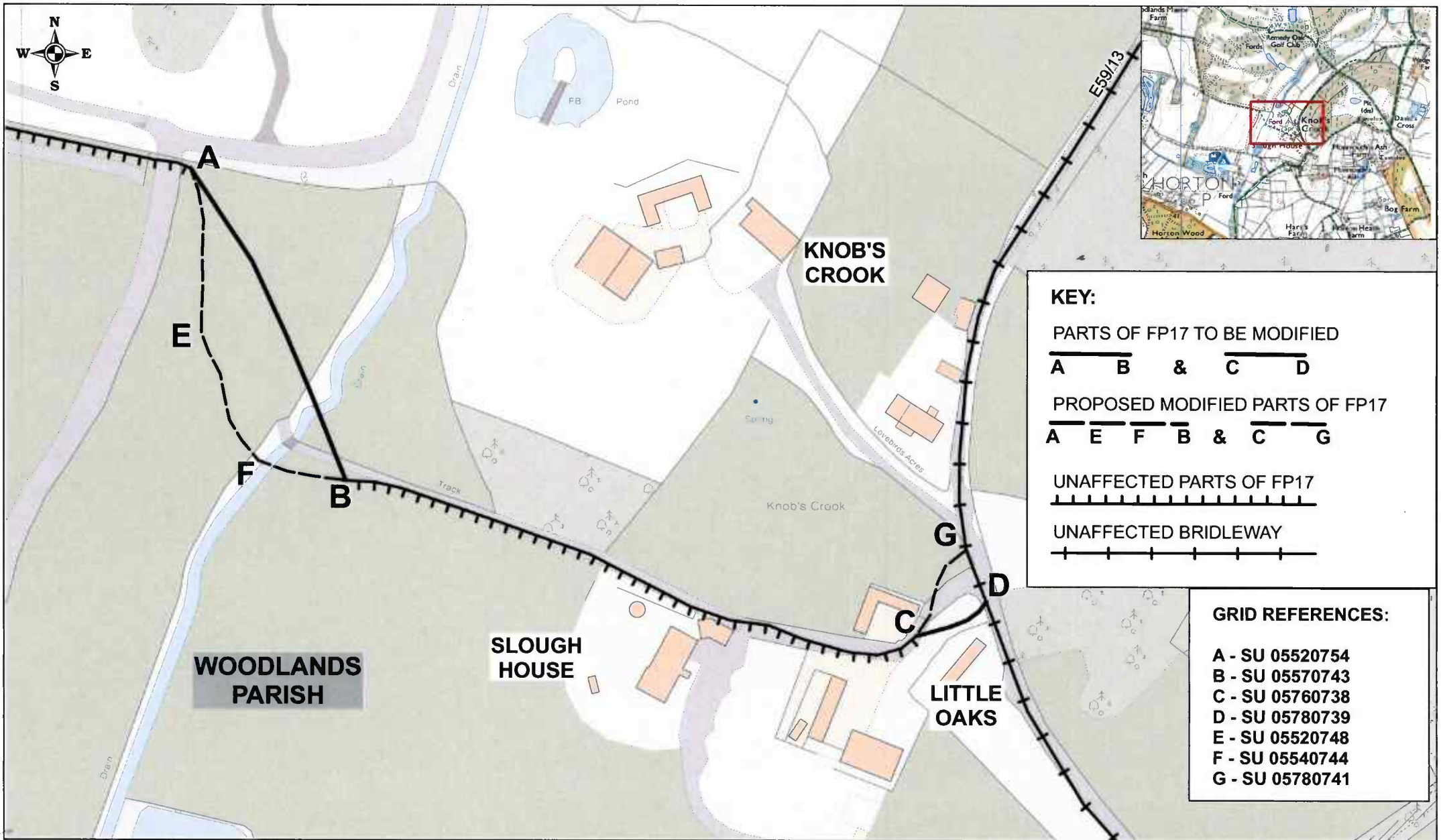

DORSET COUNCIL (PARTS OF FOOTPATH 17, WOODLANDS AT SLOUGH HOUSE) DEFINITIVE MAP AND STATEMENT MODIFICATION ORDER 2023

[Handwritten signature]

Ref: T724/22/1
 Date: 22/02/2023
 Scale: 1:1700
 Drawn by: KJD
 Cent X: 405,701
 Cent Y: 107,457



© Crown copyright and database rights 2023
 OS 0100060963. Aerial Photography ©
 UKPerspectives 2002 & © Getmapping 2005, 2009
 & 2014, © Getmapping Plc and Bluesky International
 Limited (2017 onwards)